

Hinged service room doors FT1 / FT2

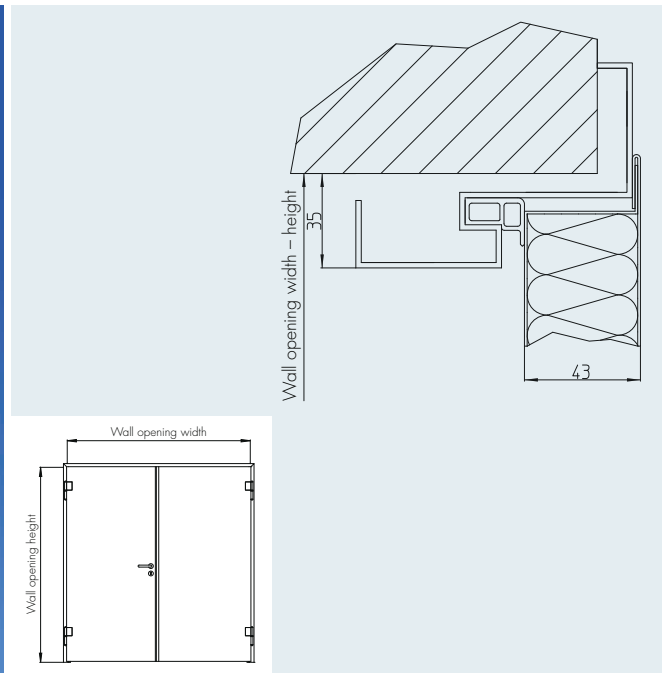

Wall opening (width x height)

Standard dimensions

_____ x _____ mm

from: 500 x 500 mm
to: 2750 x 2750 mm

Other dimensions available on request.

Surface

- Polished, grain size 240
- Stripe finish
- Circular brush finish

Other finishes available on request.

Opening direction

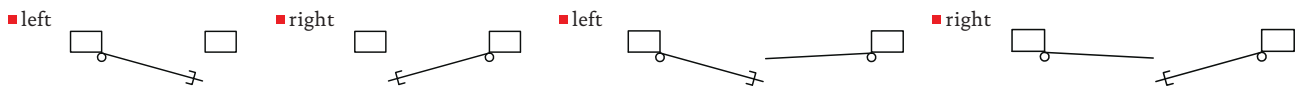

Frames

- Corner frame (EZD) ³⁾
- Surrounding frame (UZD) ³⁾
- Block frame (BZD) ³⁾
- Clamping frame (KLZ) ⁴⁾

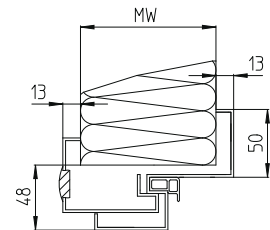
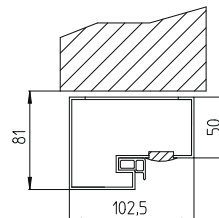
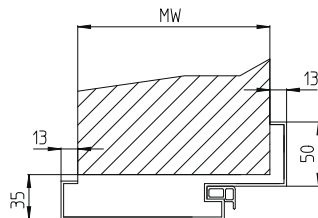
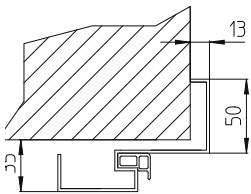

Description for use in tenders

Hinged service room door, model FT1 / FT2; with corner frame made in sheet steel, thickness 2.0 mm; with seal on 3 sides; door leaf 43 mm thick, thin folded on 3 sides, fully sealed, double-wall construction in machine-straightened sheet steel, thickness 1.0 mm; with internal stainless steel stiffening profiles; suitable for retrofitting with door-closing mechanism; flat, with rigid PUR HD foam insulation, CFC-free; DIN 18250 class 4 lock with stainless steel face plate, profile cylinder hole; DIN 18273 stainless steel handle set; 2 stainless steel construction hinges (180 mm) with axial ball bearings per leaf, for minimum friction.

Material

- 1.4301 (AISI 304)
- 1.4571 (AISI 316 Ti) ¹⁾

¹⁾ hinges 1.4301 ²⁾ not suitable for outside doors ³⁾ Installation in masonry and concrete walls ⁴⁾ PU element installation