

Hinged fire doors T301 / T302

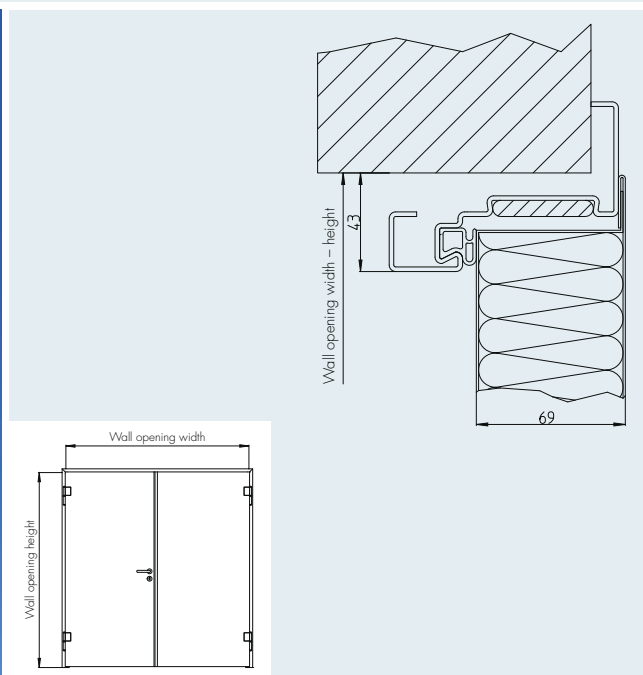

Wall opening (width x height)

_____ x _____ mm

Standard dimensions

from: 500 x 500 mm
to: 2625 x 2750 mm
Other dimensions available on request.

Surface

- Polished, grain size 240
- Stripe finish
- Circular brush finish

Other finishes available on request.

Opening direction

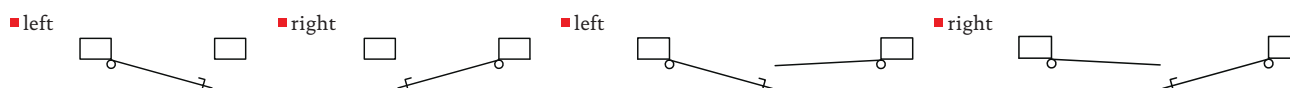

Frames

- Corner frame (EZD) ³⁾
- Block frame (BZD) ³⁾
- Corner frame with counter frame (EZDGGZ) ³⁾

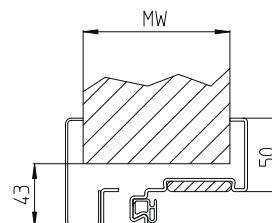
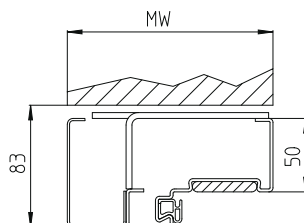
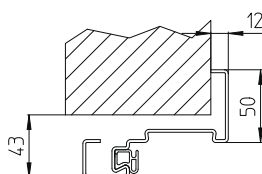

Description for use in tenders

Hinged fire-retardant door, model T301 / T302, System Schröders; fire-resistant for min 30 minutes; with corner frame made in sheet steel, thickness 2.0 mm; with seal on 3 sides; door leaf 69 mm thick, thin folded on 3 sides, fully sealed, double-wall construction in machine-straightened sheet steel, thickness 1.0 mm; with internal stainless steel stiffening profiles; with door-closing mechanism; rigid mineral fibre fire insulation; DIN 18250 class 4 lock with flush stainless steel face plate, profile cylinder hole; DIN 18273 stainless steel handle set; 2 stainless steel construction hinges (200 mm) with axial ball bearings per leaf, for minimum friction. Optional: burglary protection up to RC 4.

Material

- 1.4301 (AISI 304)
- 1.4571 (AISI 316 Ti) ¹⁾