

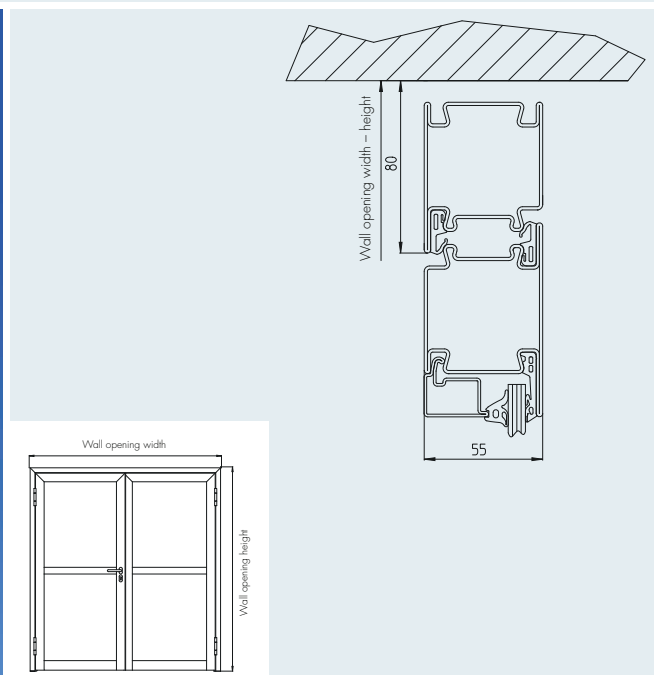

Profile door RTK1



Wall opening (width x height)

Standard dimensions

_____ x _____ mm from: 500 x 500 mm to: 2750 x 2750 mm Other dimensions available on request.

Surface

- Ground
- Stainless steel bead blasted

Other finishes available on request.

Opening direction

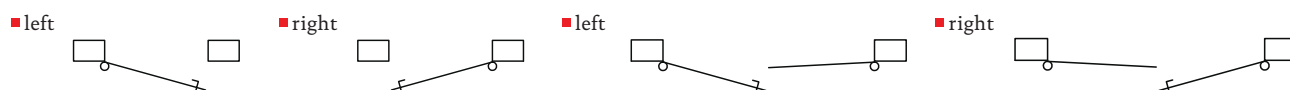

Frames

- Block frame (BZD) ³⁾

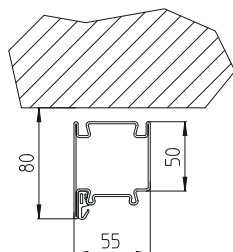

Description for use in tenders

Non-insulated frame profile door, model RTK1 / RTK2; profile depth 55 mm, fully sealed, made in extruded hollow profiles, 1.5 mm thick; frame facing and transom with grooves for seals and glazing bars; with double sealing level; welded glazing bar connections, frame and leaf corners; 8 mm laminated safety glass panes / 22 mm double-wall panels; door design according to specifications; lock with stainless steel face plate, profile cylinder hole; stainless steel handle set; with 2 butt hinges for minimum friction. Optional: burglary protection up to RC 2.

Material

- 1.4301 (AISI 304)
- 1.4401 (AISI 316 Ti) ¹⁾

¹⁾ hinges 1.4301 ²⁾ not suitable for outside doors ³⁾ Installation in masonry and concrete walls ⁴⁾ PU element installation